

a FURNITURE IDEA BOOK for 21st CENTURY LEARNING ENVIRONMENTS



VIRGINIA BEACH CITY PUBLIC SCHOOLS

AHEAD OF THE CURVE

OFFICE OF FACILITIES PLANNING & CONSTRUCTION

APRIL 2015

HBA

a FURNITURE IDEA BOOK for 21st CENTURY LEARNING ENVIRONMENTS

APRIL 2015

TABLE OF CONTENTS

1	INTRODUCTION
2	TYPICAL CLASSROOM
6	EXPERIENTIAL LAB
8	LEARNING COVE
10	SCIENCE LAB
12	STUDENT PROJECT OR COLLABORATION LAB
14	MEDIA CENTER/LEARNING COMMONS
21	FURNITURE DATA SHEETS
36	RESOURCE LINKS



VIRGINIA BEACH CITY PUBLIC SCHOOLS

A H E A D O F T H E C U R V E

OFFICE OF FACILITIES PLANNING & CONSTRUCTION



INTRODUCTION

Today's students are learning to be critical thinkers and creative innovators. They are moving beyond being consumers of information and are becoming creators of content. They are collaborating in teams and leveraging their collective intelligence to become effective problem solvers in service of our community, and they are honing their communication skills to become both respectful teammates and our future leaders.

You know these learning activities as the 5 C's of 21st Century Skills, and having the right type of learning environments, coupled with passionate and heroic teaching, will enable our young people to acquire and develop these skills into lifelong "habits of the mind".

What does a 21st Century Learning Environment look like? It is flexible and adaptable enough to provide opportunities for multiple learning configurations within a "classroom", from individual study, to small group collaborative work, to large group sharing and more traditional lecture. Beyond the "classroom", every space is within the school walls (and also outside of the school walls) is planned and programmed to support learning anytime, anywhere. Furniture is both mobile and transformable so that space can easily be reconfigured to support varied learning modalities. Chairs are comfortable and provide both workspace and storage space. Furniture for other types of sitting is available giving the students (and teachers) choice. Tables can be nested together to support collaboration or they can be stacked and consolidated to free up space for more active learning. Standing and moving about is encouraged as movement supports a greater focus on learning and also a healthier lifestyle. Markable walls, markable furniture surfaces and educational technology tools are distributed around the space to allow the transition of the learning environment from teacher-directed to student-centered. There is space and furniture to not only store the raw materials of learning but also to display and celebrate the work of the learners. And last but not least, electric power is abundant and distributed and wireless bandwidth is robust.

This Furniture Idea Book is designed to provide secondary school leaders with both a resource and a tool to begin planning 21st Century Learning Environments within your school, even if your school is a facility that was built forty to fifty years ago. As you begin your journey, please know that this is only a beginning, and that every day, educational planners and furniture designers are adding to the idea and product landscape in support of high-quality learning environments for today's learners. So be curious. Make your decisions in the context of what is best for learning. And let your only limitation be your imagination.

TYPICAL CLASSROOM LAYOUT 1

675 SF

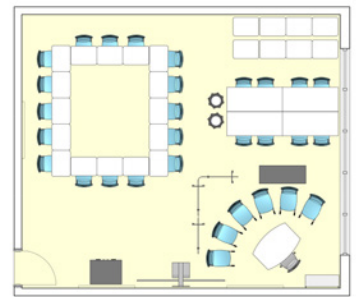
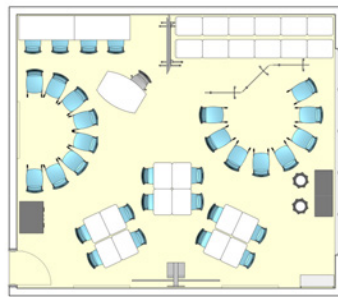
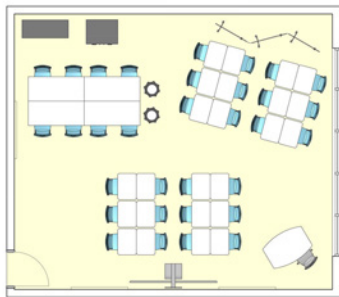
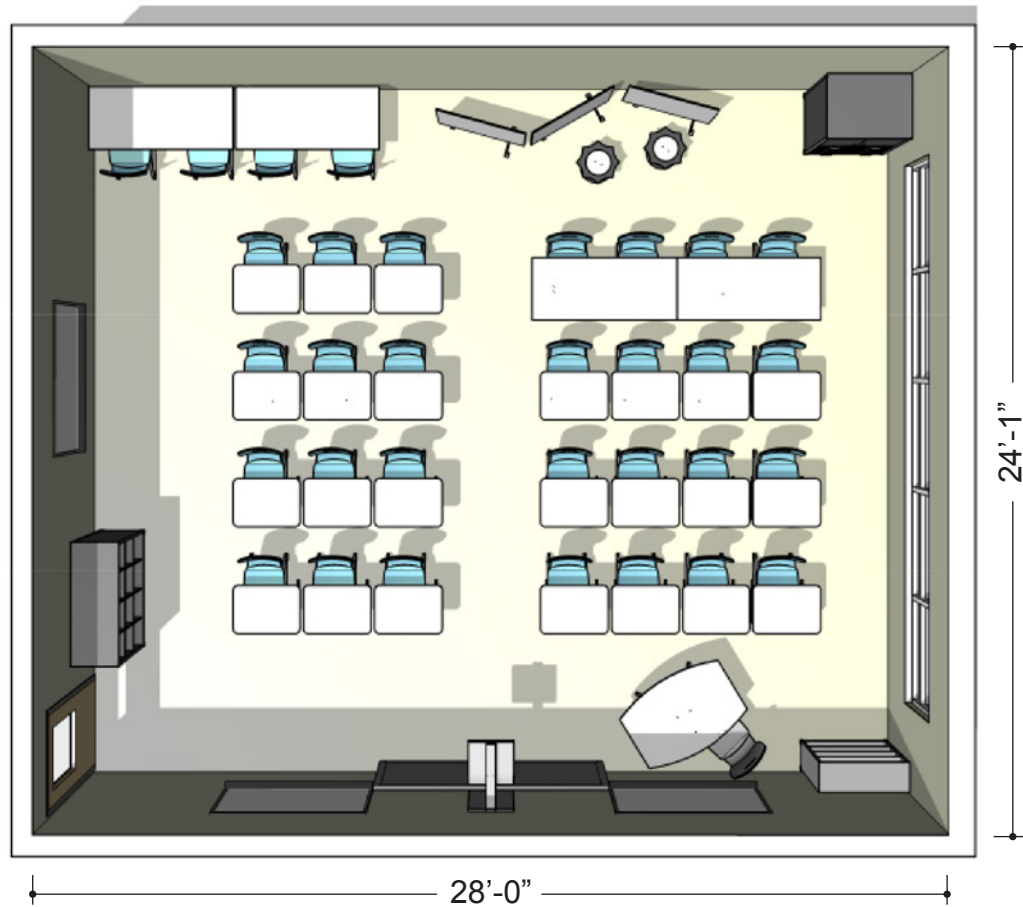

CODE	ITEM	MANUFACTURER	QTY.	UNIT COST	TOTAL
VS-01	Uno-M Student Desk	VS-America	24	\$136.58	\$3,277.82
VR-01	Sage Cantilever Student Chair	Virco	32	\$72.83	\$2,330.56
VR-03	Sage Task Lab - Teacher Chair	Virco	1	\$166.95	\$166.95
VS-03	Hokki Stool	VS-America	2	\$89.24	\$178.48
VS-04	Rondo-Lift Teacher Table	VS-America	1	\$1,087.18	\$1,087.18
VS-02	FlipTable-RU	VS-America	4	\$456.29	\$1,825.15
VS-07	Folding Screen	VS-America	1	\$2,835.50	\$2,835.50
VS-06	Mobile Storage - Cubbies	VS-America	1	\$1,157.80	\$1,157.80
VS-05	Mobile Storage - Drawers	VS-America	1	\$1,687.80	\$1,687.80
VR-04	Mobile Bookshelf	Virco	1	\$358.04	\$358.04
ESTIMATED CLASSROOM TOTAL (2015 DOLLARS):					\$14,905.29

TYPICAL CLASSROOM LAYOUT 2

675 SF

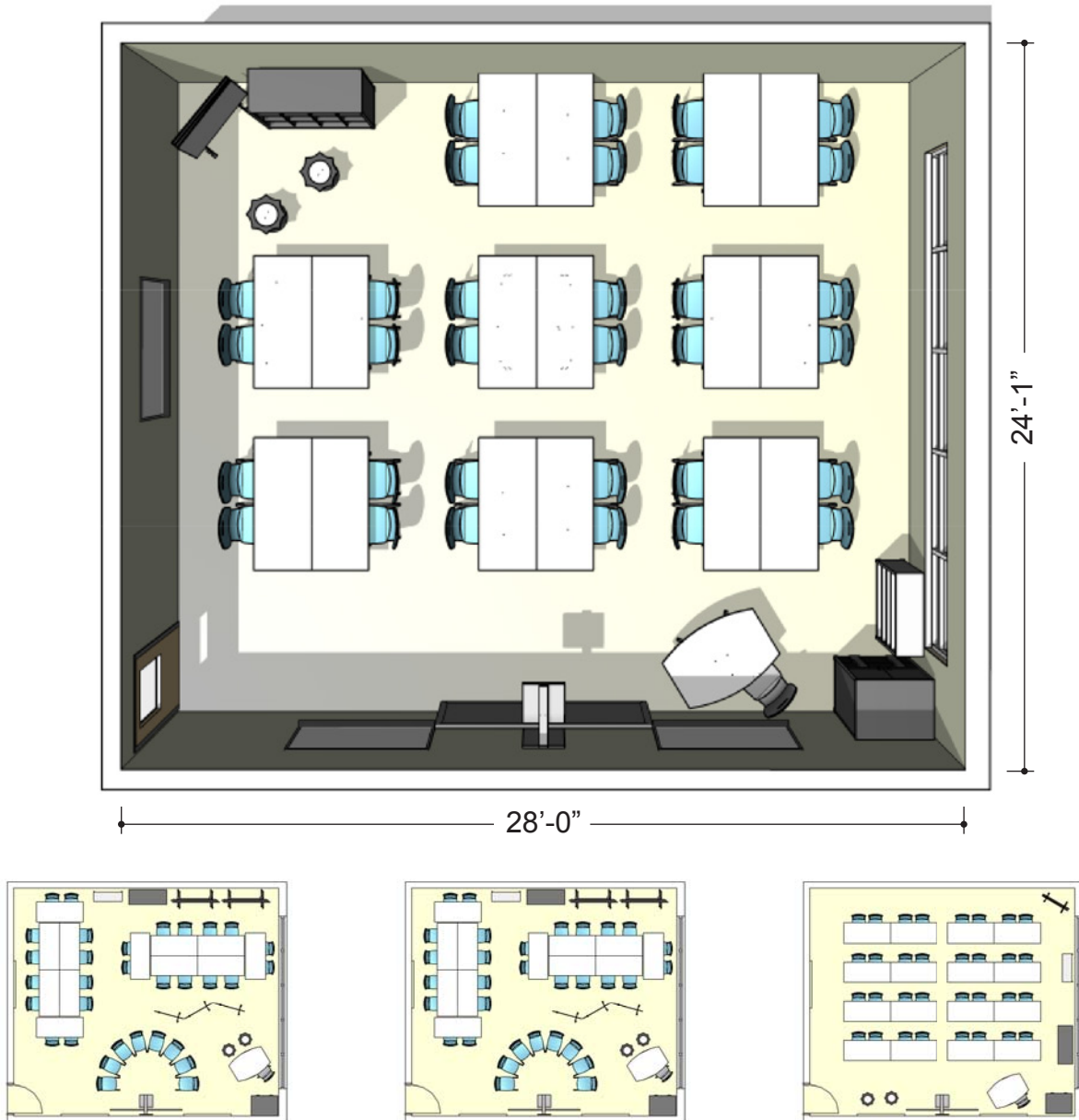

CODE	ITEM	MANUFACTURER	QTY.	UNIT COST	TOTAL
VR-01	Sage Cantilever Student Chair	Virco	32	\$72.83	\$2,330.56
VR-03	Sage Task Lab - Teacher Chair	Virco	1	\$166.95	\$166.95
VS-03	Hokki Stool	VS-America	2	\$89.24	\$178.48
VS-04	Rondo-Lift Teacher Table	VS-America	1	\$1,087.18	\$1,087.18
VS-02	FlipTable-RU	VS-America	16	\$456.29	\$7,300.61
VS-07	Folding Screen	VS-America	1	\$2,835.50	\$2,835.50
VS-06	Mobile Storage - Cubbies	VS-America	1	\$1,157.80	\$1,157.80
VS-05	Mobile Storage - Drawers	VS-America	1	\$1,687.80	\$1,687.80
VS-04	Mobile Bookshelf	Virco	1	\$358.04	\$358.04
ESTIMATED CLASSROOM TOTAL (2015 DOLLARS):					\$17,102.92

TYPICAL CLASSROOM LAYOUT 3

675 SF

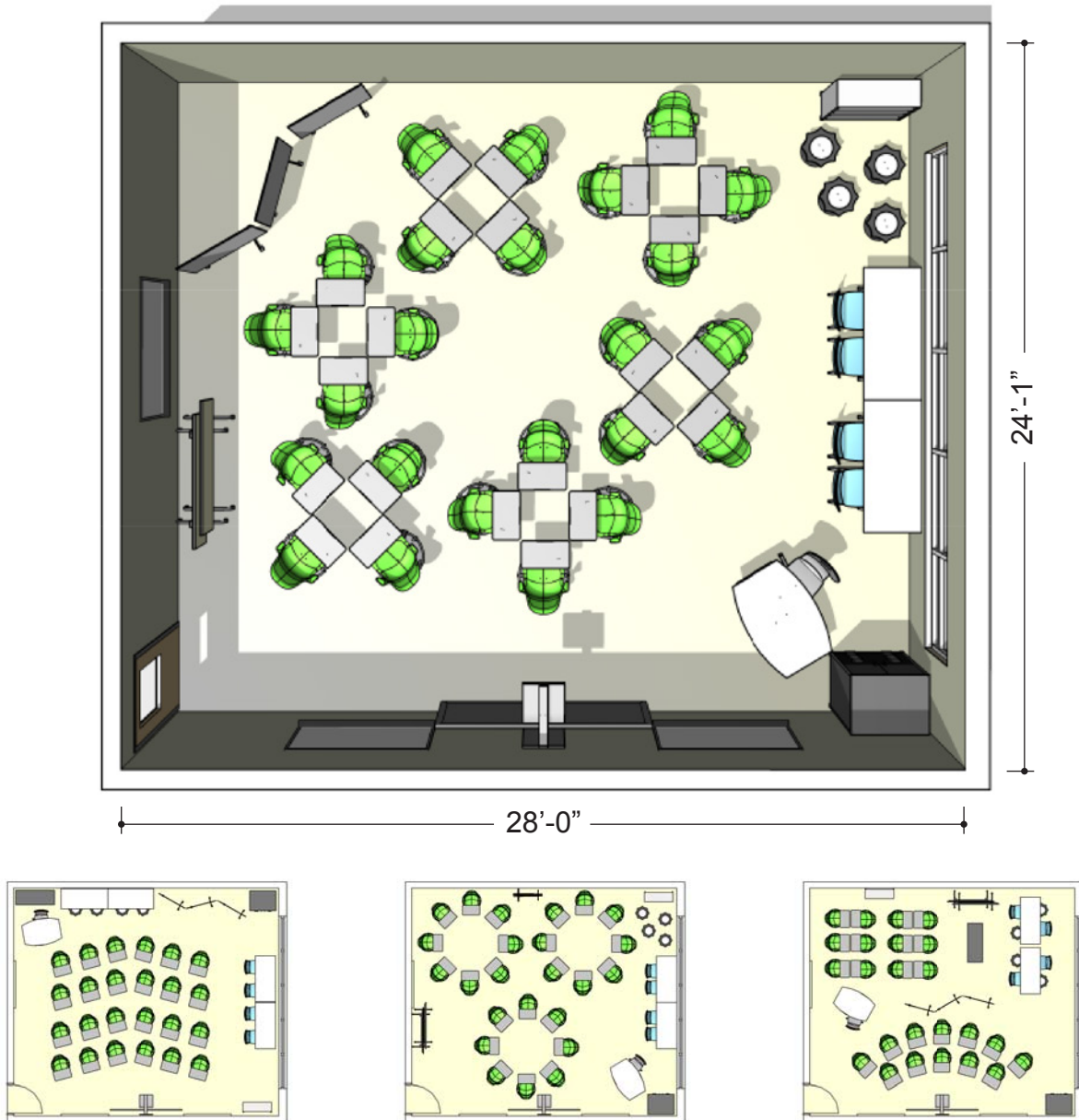

CODE	ITEM	MANUFACTURER	QTY.	UNIT COST	TOTAL
VR-01	Sage Cantilever Student Chair	Virco	4	\$72.83	\$291.32
SC-01	Node - Student Desk/Chair	Steelcase	24	\$357.50	\$8,580.00
VR-03	Sage Task Lab - Teacher Chair	Virco	1	\$166.95	\$166.95
VS-03	Hokki Stool	VS-America	4	\$89.24	\$356.96
VS-04	Rondo-Lift Teacher Table	VS-America	1	\$1,087.18	\$1,087.18
VS-02	FlipTable-RU	VS-America	4	\$456.29	\$1,825.15
VS-07	Folding Screen	VS-America	1	\$2,835.50	\$2,835.50
VS-06	Mobile Storage - Cubbies	VS-America	1	\$1,157.80	\$1,157.80
VS-05	Mobile Storage - Drawers	VS-America	1	\$1,687.80	\$1,687.80
VR-04	Mobile Bookshelf	Virco	1	\$358.04	\$358.04
ESTIMATED CLASSROOM TOTAL (2015 DOLLARS):					\$18,346.70

TYPICAL CLASSROOM LAYOUT 4
675 SF

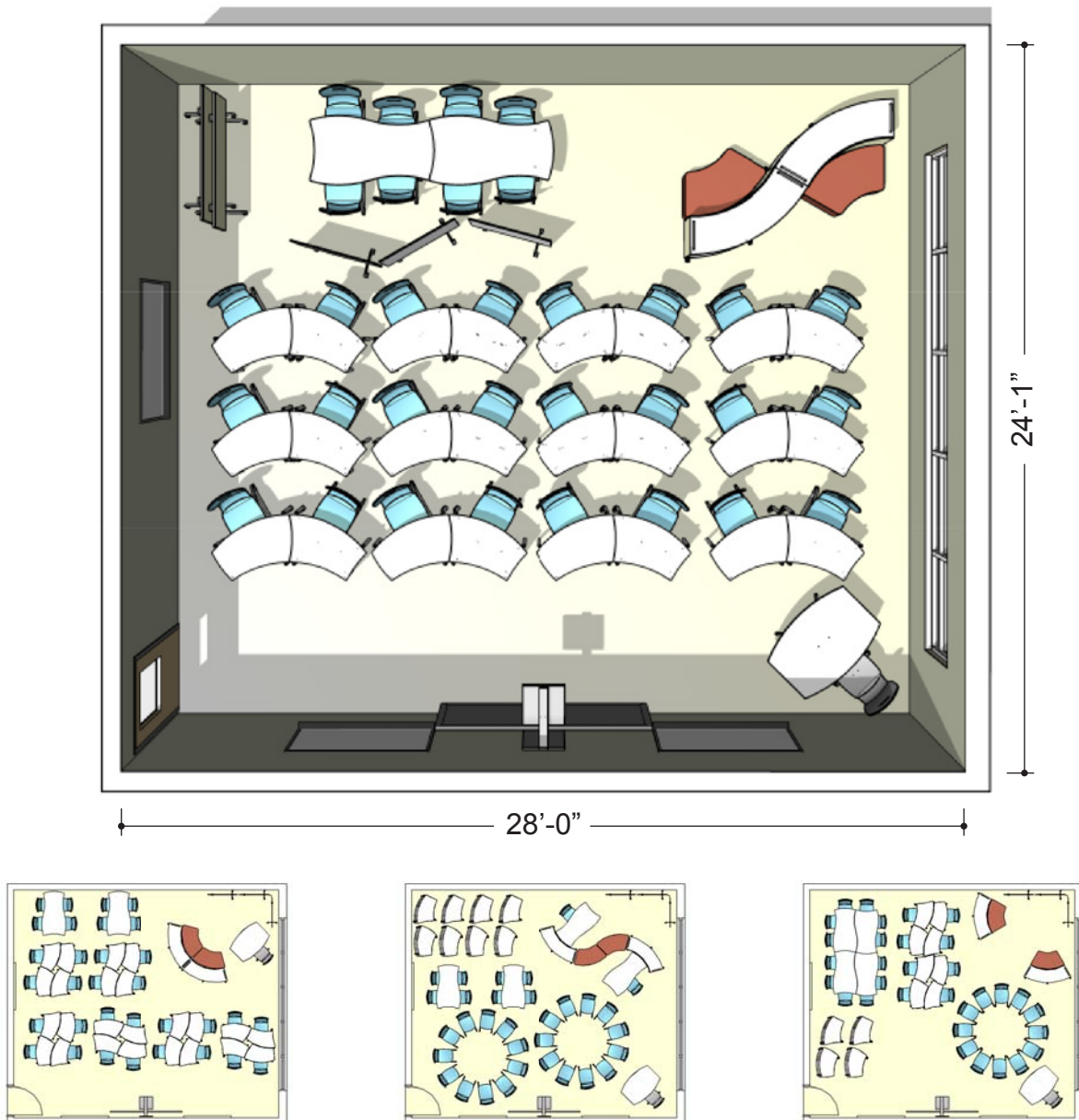

CODE	ITEM	MANUFACTURER	QTY.	UNIT COST	TOTAL
VS-08	Shift+ Convex Student Desk	VS-America	12	\$221.94	\$2,663.23
VS-09	Shift+ Concave Student Desk	VS-America	12	\$221.94	\$2,663.23
VR-01	Sage Cantilever Student Chair	Virco	32	\$72.83	\$2,330.56
VR-03	Sage Task Lab - Teacher Chair	Virco	1	\$166.95	\$166.95
VS-04	Rondo-Lift Teacher Table	VS-America	1	\$1,087.18	\$1,087.18
VS-10	Shift+ Fusion FlipTable	VS-America	4	\$498.19	\$1,992.77
VS-07	Folding Screen	VS-America	1	\$2,835.50	\$2,835.50
VS-12	Shift+ Landscape 60° - Bookshelf	VS-America	2	\$1,149.26	\$2,298.51
VS-14	Shift+ Landscape 60° - Seat	VS-America	2	\$798.50	\$1,597.01
ESTIMATED CLASSROOM TOTAL (2015 DOLLARS):					\$17,634.94

EXPERIENTIAL LAB LAYOUT 1

1,173 SF

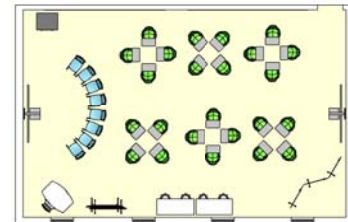
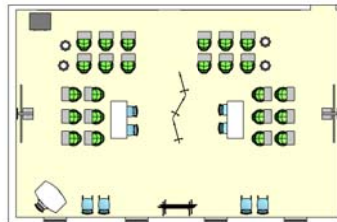
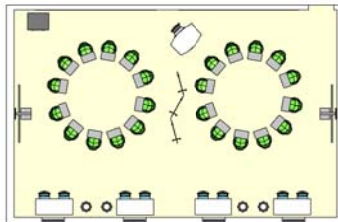
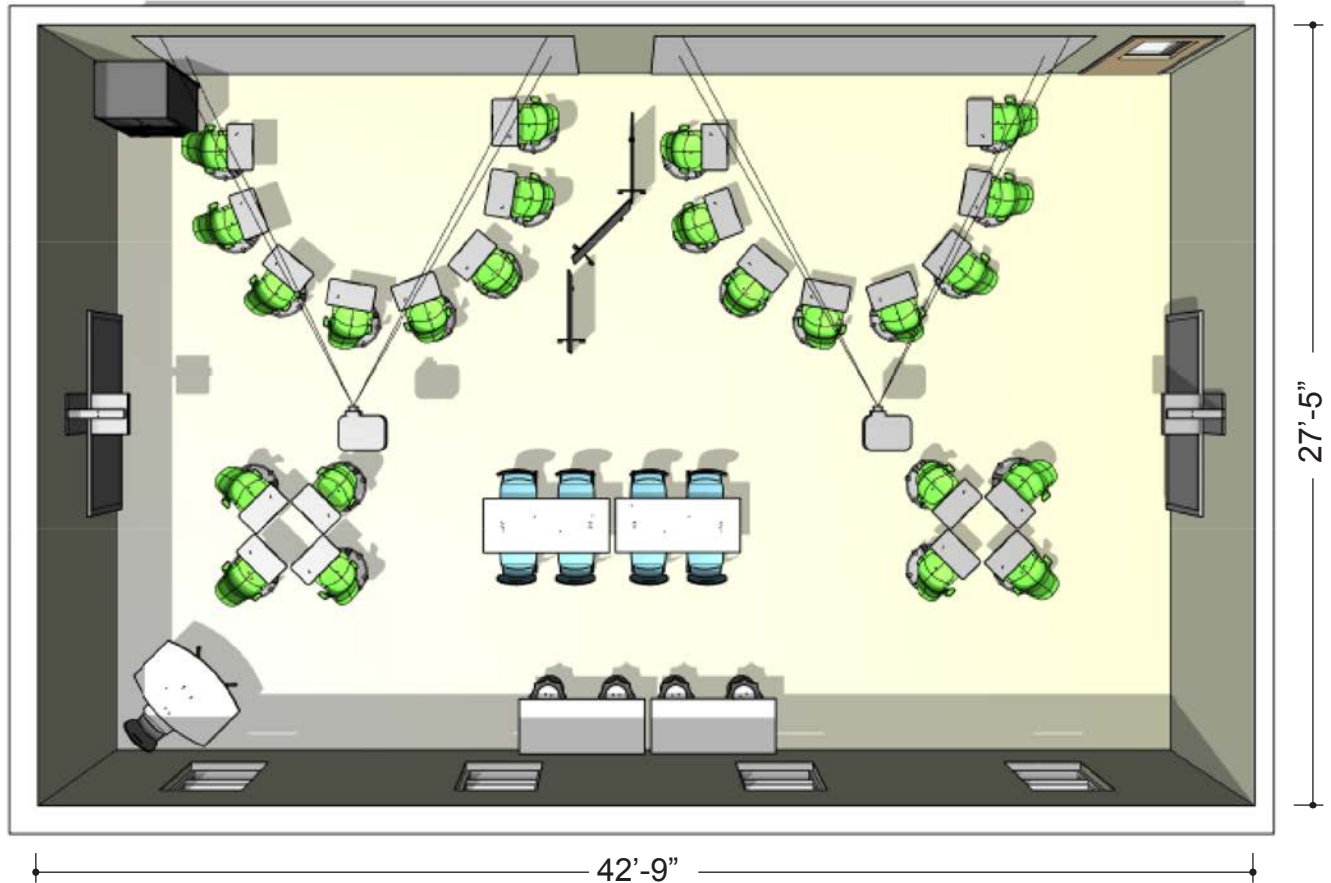

CODE	ITEM	MANUFACTURER	QTY.	UNIT COST	TOTAL
SC-01	Node - Student Desk/Chair	Steelcase	24	\$357.50	\$8,580.00
VR-03	Sage Task Lab - Teacher Chair	Virco	1	\$166.95	\$166.95
VR-01	Sage Cantilever Student Chair	Virco	8	\$72.83	\$582.64
VS-03	Hokki Stool	VS-America	4	\$89.24	\$356.96
VS-04	Rondo-Lift Teacher Table	VS-America	1	\$1,087.18	\$1,087.18
VS-02	FlipTable-RU	VS-America	4	\$456.29	\$1,825.15
VS-07	Folding Screen	VS-America	1	\$2,835.50	\$2,835.50
SW-01	Sharewall - 4'x8'	Sharewall	4	\$319.60	\$1,278.40
VS-05	Mobile Storage - Drawers	VS-America	1	\$1,687.80	\$1,687.80
ESTIMATED CLASSROOM TOTAL (2015 DOLLARS):					\$18,400.58

EXPERIENTIAL LAB LAYOUT 2

1,173 SF

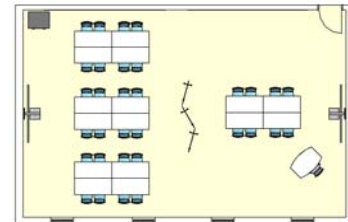
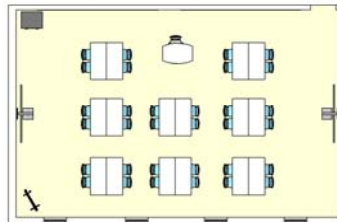
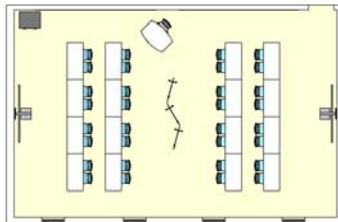
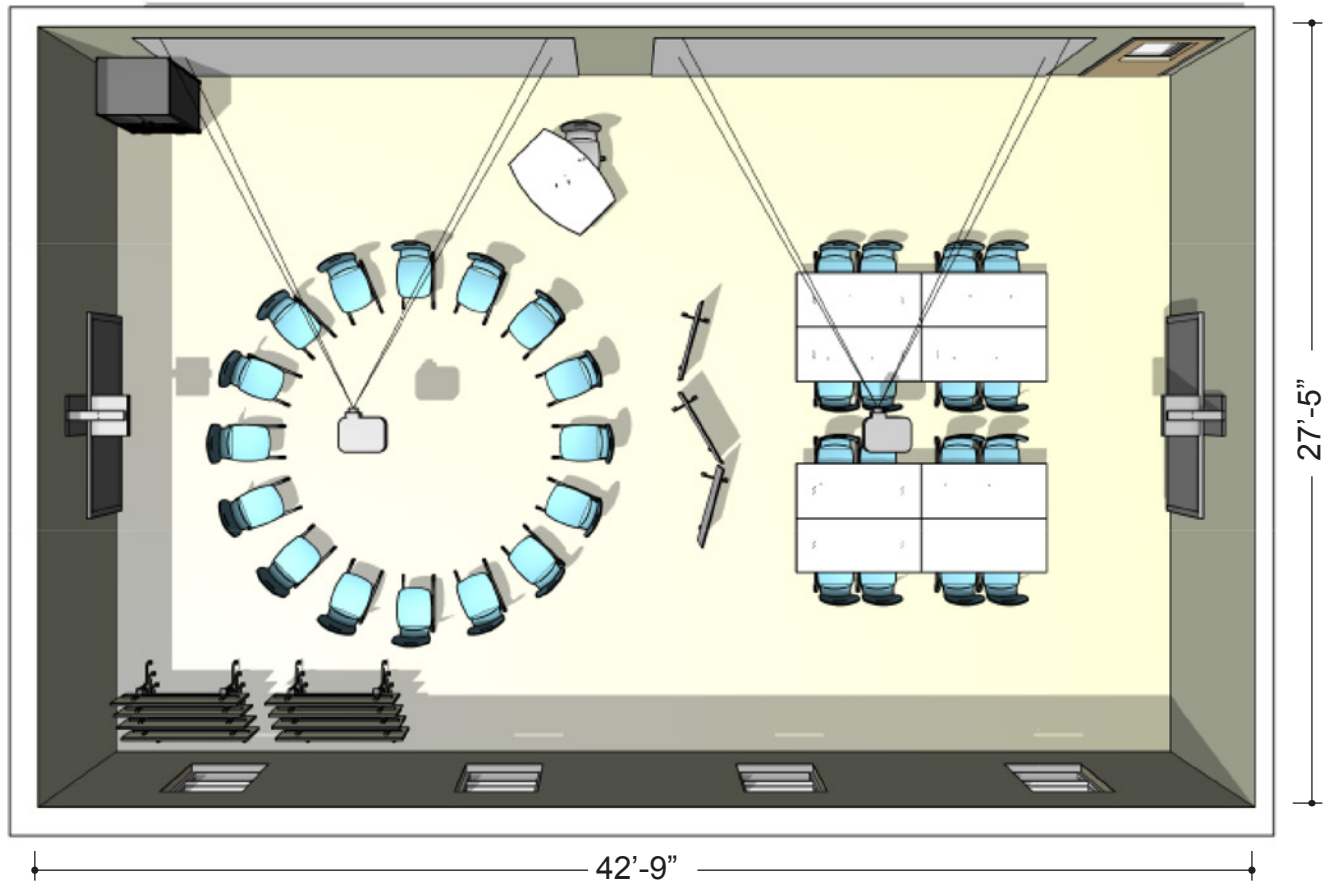

CODE	ITEM	MANUFACTURER	QTY.	UNIT COST	TOTAL
VR-01	Sage Cantilever Student Chair	Virco	32	\$72.83	\$2,330.56
VR-03	Sage Task Lab - Teacher Chair	Virco	1	\$166.95	\$166.95
VS-04	Rondo-Lift Teacher Table	VS-America	1	\$1,087.18	\$1,087.18
VS-02	FlipTable-RU	VS-America	16	\$456.29	\$7,300.61
VS-07	Folding Screen	VS-America	1	\$2,835.50	\$2,835.50
SW-01	Sharewall - 4'x8'	Sharewall	4	\$319.60	\$1,278.40
VS-05	Mobile Storage - Drawers	VS-America	1	\$1,687.80	\$1,687.80
ESTIMATED CLASSROOM TOTAL (2015 DOLLARS):					\$16,687.00

364 SF

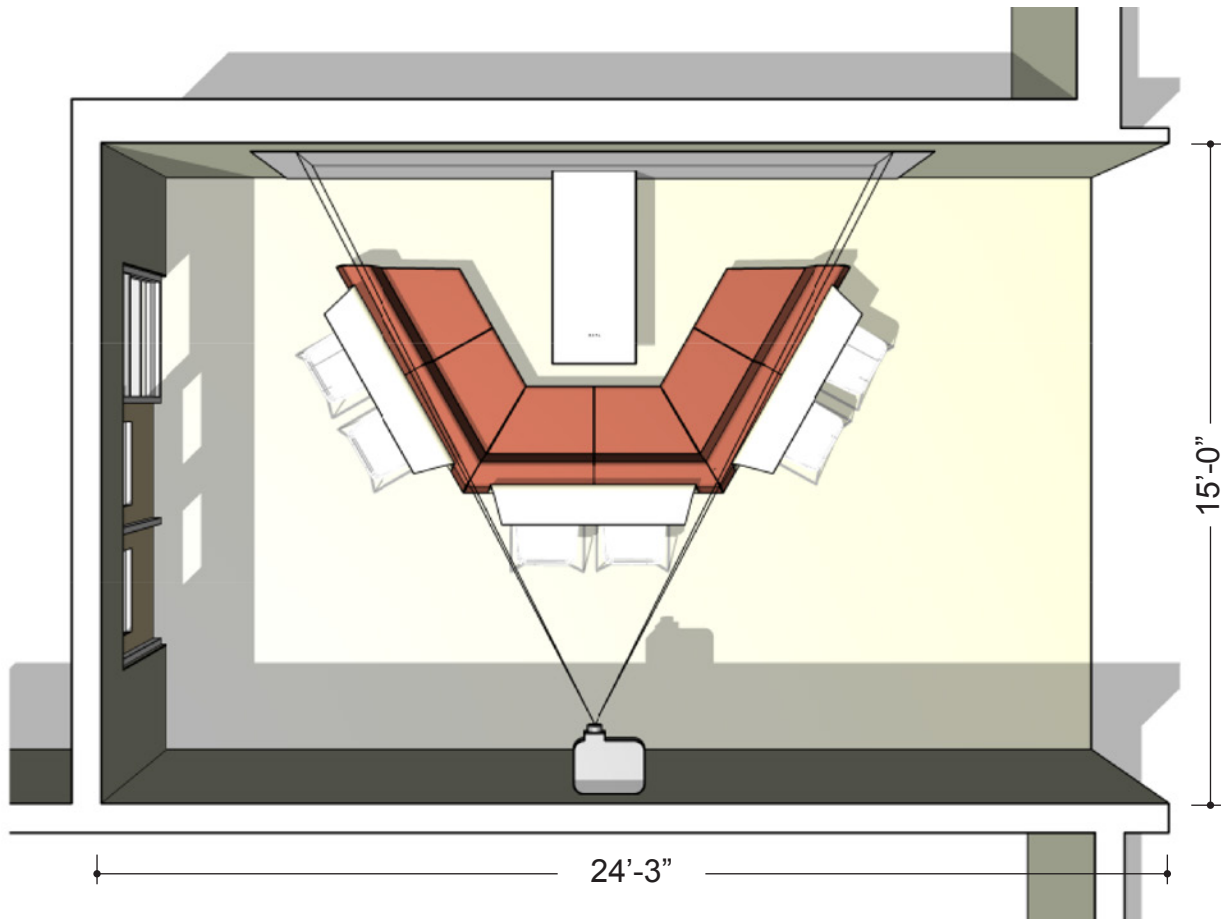

CODE	ITEM	MANUFACTURER	QTY.	UNIT COST	TOTAL
VS-02	FlipTable-RU	VS-America	1	\$456.29	\$456.29
SC-02	Media:Scape	Steelcase	3	\$3,358.92	\$10,076.76
TS-01	Scoop Stool	Turnstone	6	\$163.30	\$979.80
SW-01	Sharewall - 4'x8'	Sharewall	4	\$319.60	\$1,278.40
ESTIMATED CLASSROOM TOTAL (2015 DOLLARS):					\$12,791.25

LEARNING COVE LAYOUT 2

364 SF

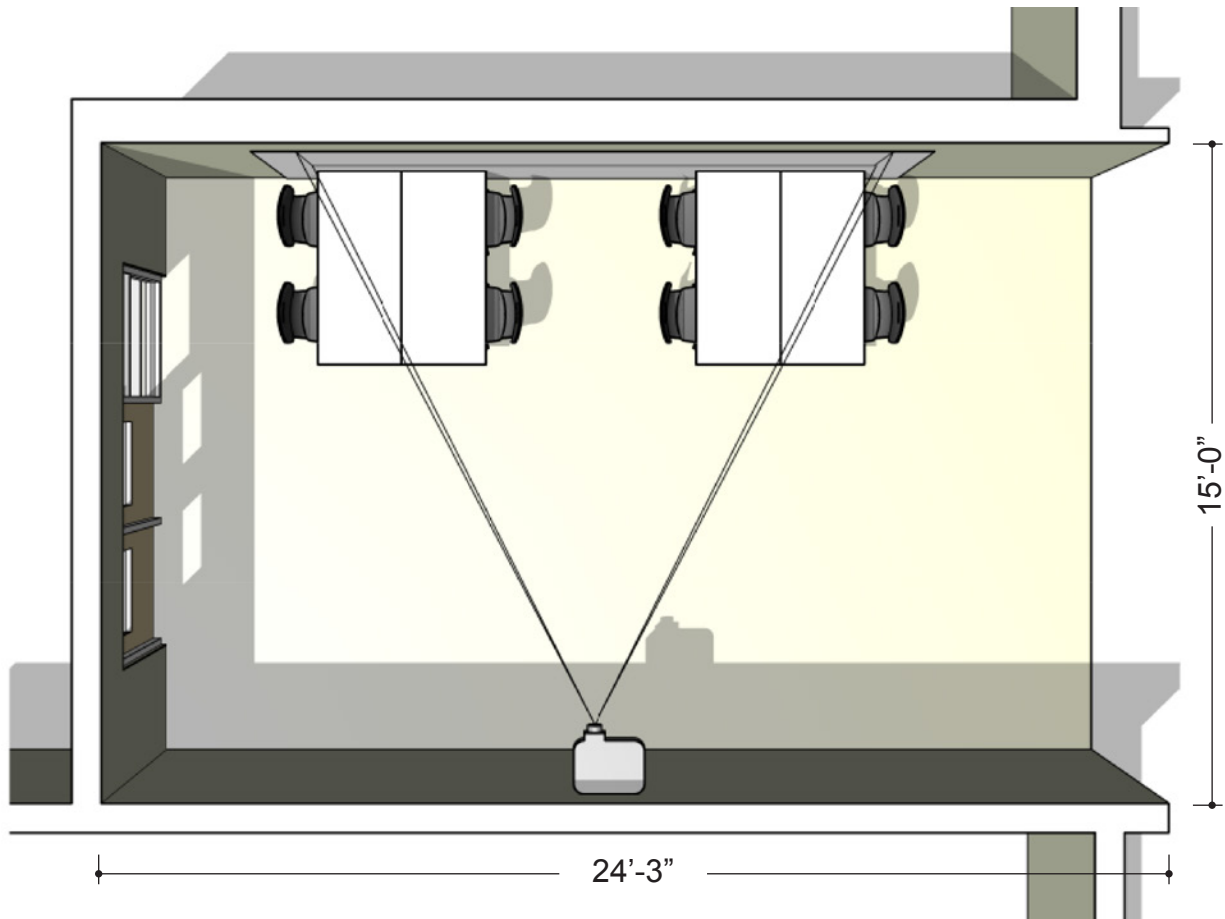

CODE	ITEM	MANUFACTURER	QTY.	UNIT COST	TOTAL
VS-02	FlipTable-RU	VS-America	4	\$456.29	\$1,825.15
VR-02	Sage Task Chair	Virco	8	\$141.33	\$1,130.64
SW-01	Sharewall - 4'x8'	Sharewall	4	\$319.60	\$1,278.40
ESTIMATED CLASSROOM TOTAL (2015 DOLLARS):					\$4,234.19

SCIENCE LAB LAYOUT 1

952 SF

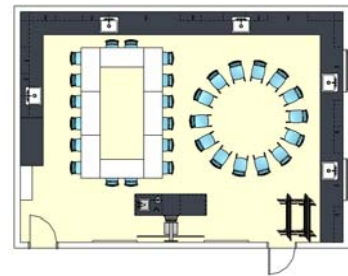
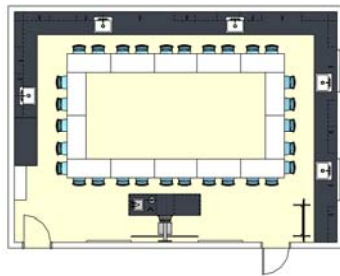
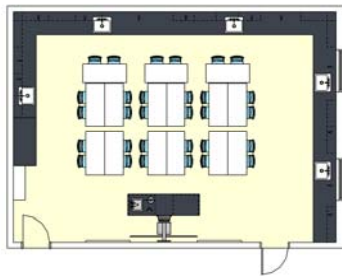
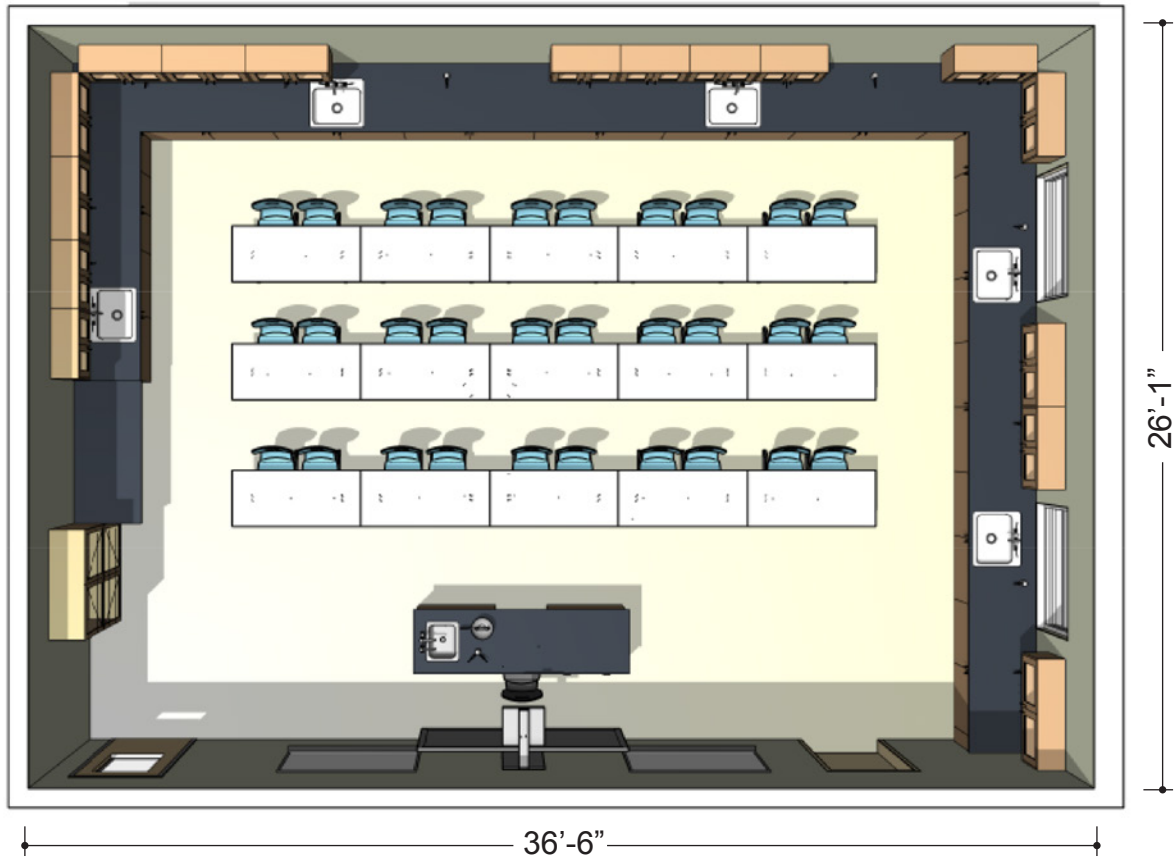

CODE	ITEM	MANUFACTURER	QTY.	UNIT COST	TOTAL
VR-01	Sage Cantilever Student Chair	Virco	30	\$72.83	\$2,184.90
VR-02	Sage Task Chair	Virco	1	\$141.33	\$141.33
VS-02	FlipTable-RU	VS-America	15	\$456.29	\$6,844.32
ESTIMATED CLASSROOM TOTAL (2015 DOLLARS):					\$9,170.55

SCIENCE LAB LAYOUT 2

969 SF

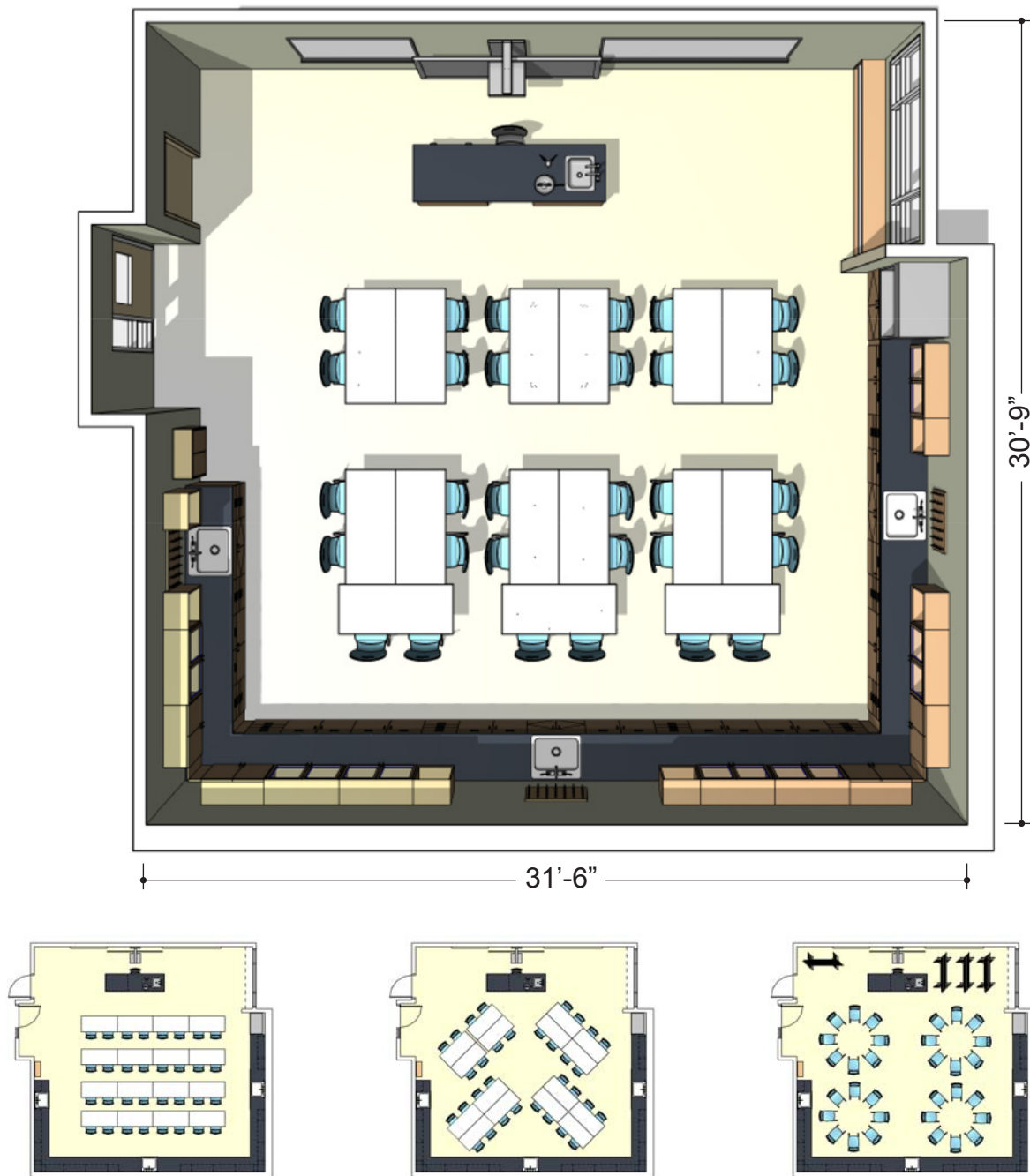

CODE	ITEM	MANUFACTURER	QTY.	UNIT COST	TOTAL
VR-01	Sage Cantilever Student Chair	Virco	30	\$72.83	\$2,184.90
VR-02	Sage Task Chair	Virco	1	\$141.33	\$141.33
VS-02	FlipTable-RU	VS-America	15	\$456.29	\$6,844.32
ESTIMATED CLASSROOM TOTAL (2015 DOLLARS):					\$9,170.55

STUDENT PROJECT OR COLLOBORATION LAB LAYOUT 1

357 SF

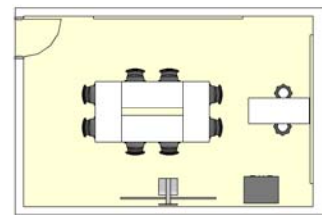
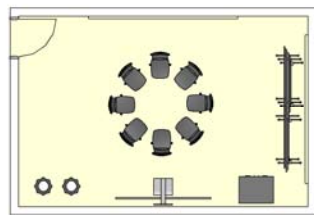
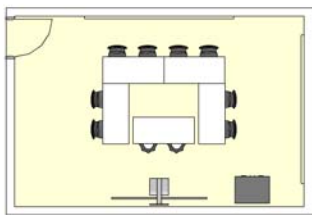
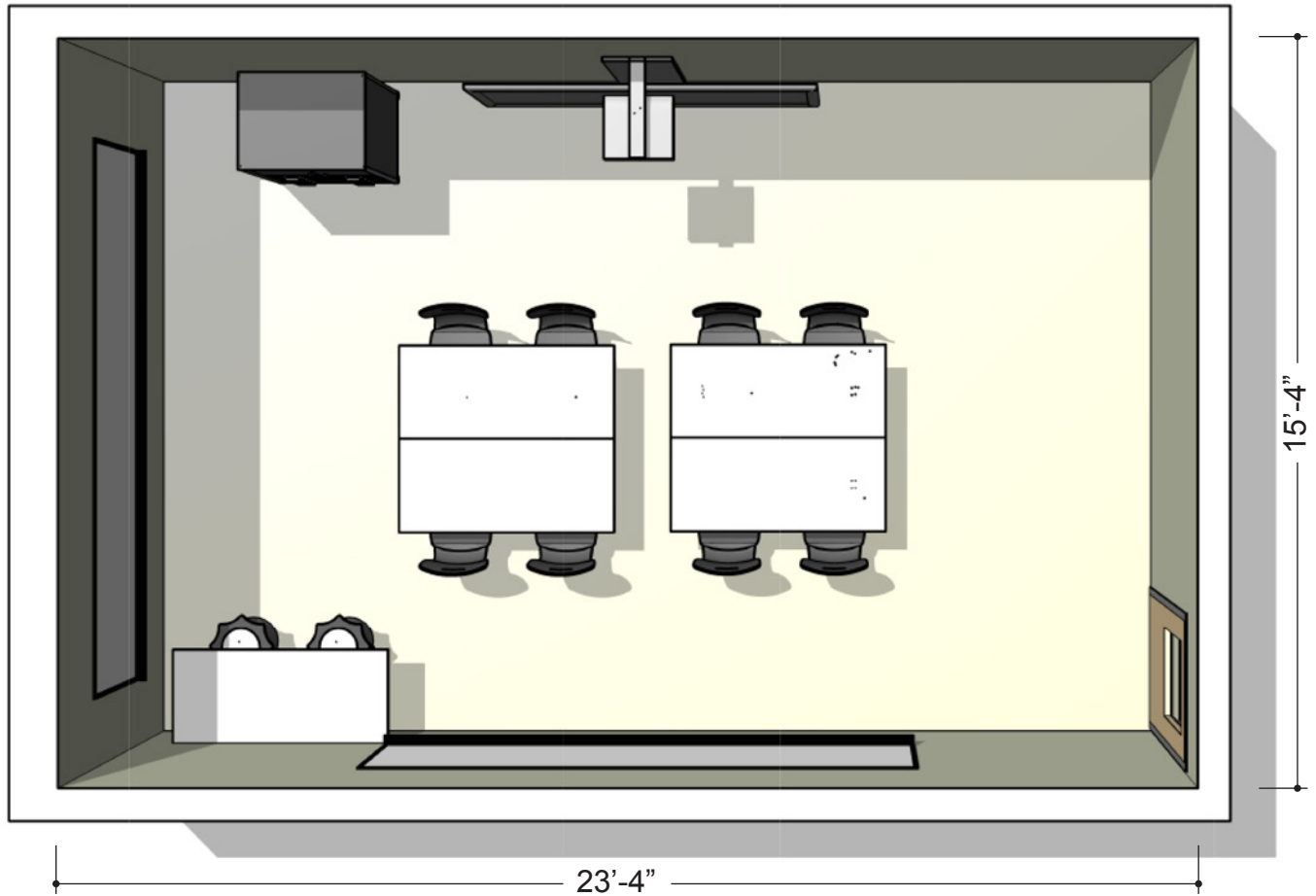

CODE	ITEM	MANUFACTURER	QTY.	UNIT COST	TOTAL
VR-02	Sage Task Chair	Virco	8	\$141.33	\$1,130.64
VS-02	FlipTable-RU	VS-America	5	\$456.29	\$2,281.44
VS-03	Hokki Stool	VS-America	2	\$89.24	\$178.48
VS-05	Mobile Storage - Drawers	VS-America	1	\$1,687.80	\$1,687.80
ESTIMATED CLASSROOM TOTAL (2015 DOLLARS):					\$5,278.36

STUDENT PROJECT AND COLLABORATION LAB LAYOUT 2

357 SF

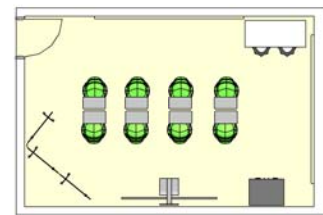
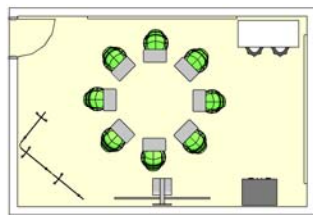
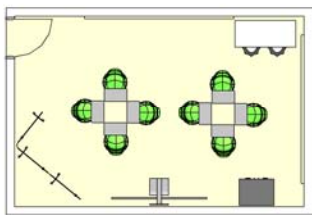
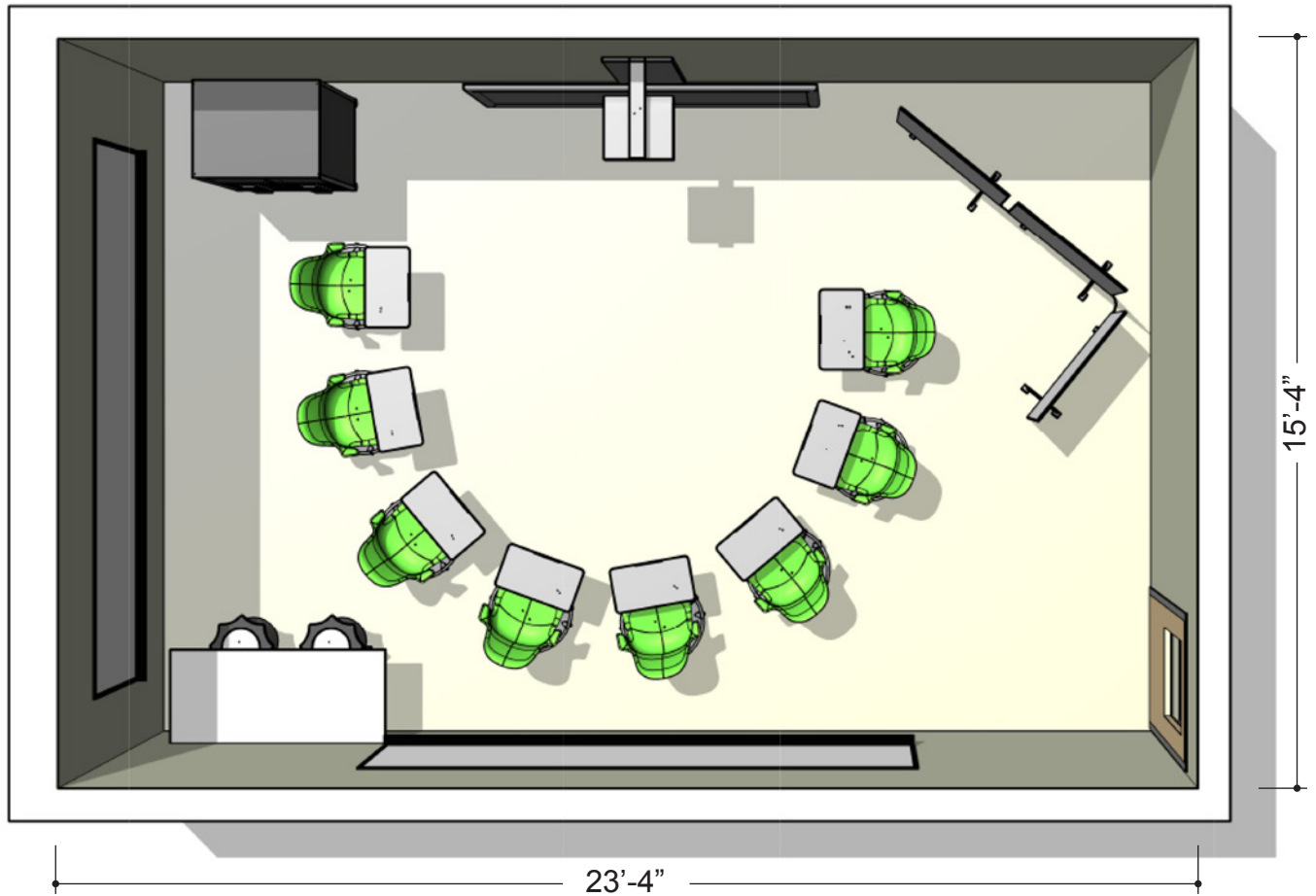

CODE	ITEM	MANUFACTURER	QTY.	UNIT COST	TOTAL
SC-01	Node - Student Desk/Chair	Steelcase	8	\$357.50	\$2,860.00
VS-03	Hokki Stool	VS-America	2	\$89.24	\$178.48
VS-02	FlipTable-RU	VS-America	1	\$456.29	\$456.29
VS-07	Folding Screen	VS-America	1	\$2,835.50	\$2,835.50
VS-05	Mobile Storage - Drawers	VS-America	1	\$1,687.80	\$1,687.80
ESTIMATED CLASSROOM TOTAL (2015 DOLLARS):					\$8,018.07

MEDIA CENTER LAYOUT 1
5,395 SF

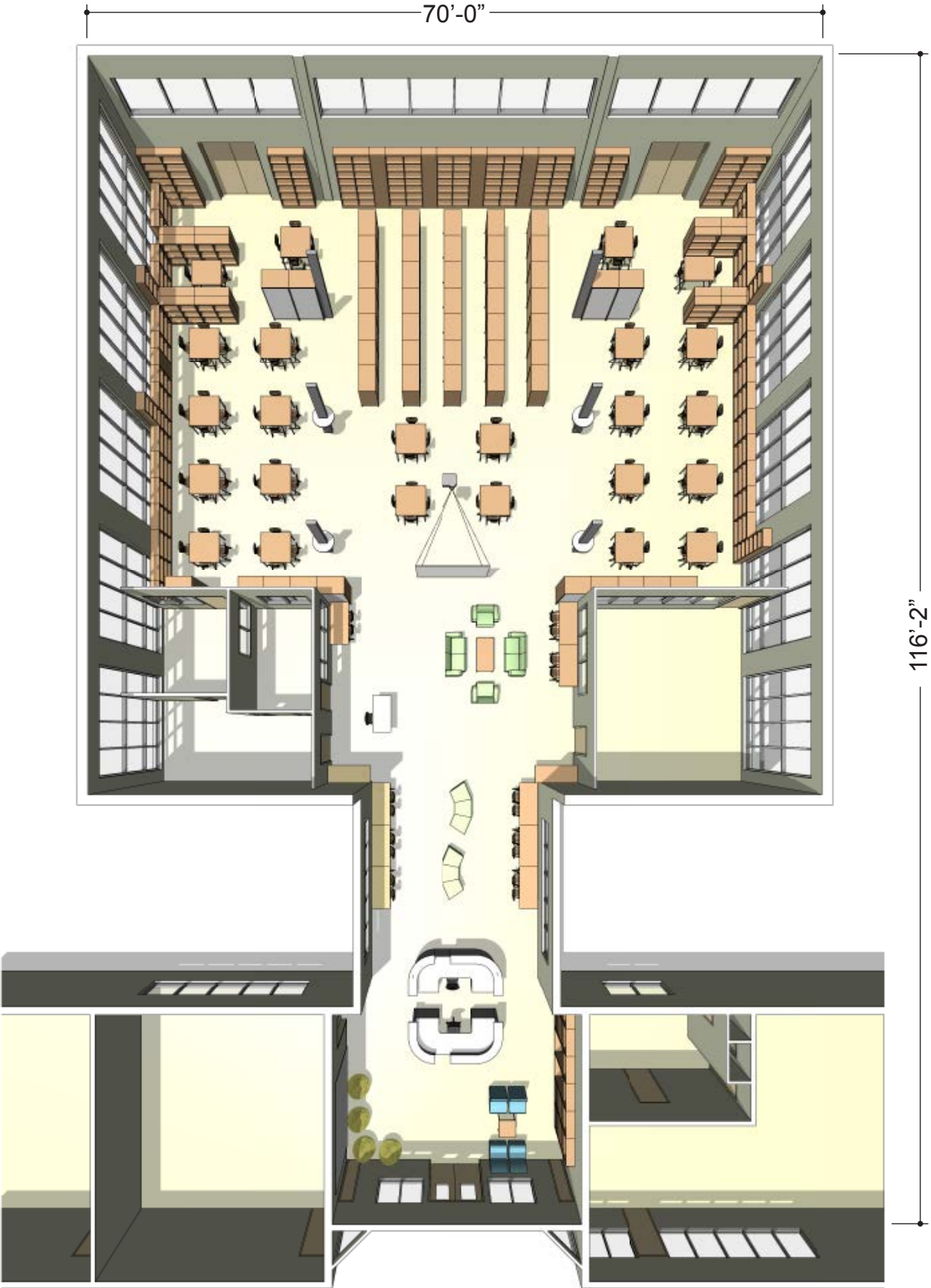

MEDIA CENTER LAYOUT 1

CODE	ITEM	MANUFACTURER	QTY.	UNIT COST	TOTAL
MT-01	48" H Mobile Bookshelf	Media Technologies	35	\$912.65	\$31,942.75
VS-17	NetWork Student Table - 2 student	VS-America	2	\$246.77	\$493.54
VS-18	NetWork Student Table - 4 student	VS-America	22	\$262.29	\$5,770.34
VS-20	Uno-M Teacher Desk	VS-America	1	\$423.70	\$423.70
AM-01	Circulation Desk	AM Case	1	\$8,925.00	\$8,925.00
CE-05	Encore - Backless Lounge	Community	6	\$488.00	\$2,928.00
CE-06	Encore - Armless Lounge	Community	4	\$675.00	\$2,700.00
CE-01	Encore - Single Lounge	Community	2	\$1,262.75	\$2,525.50
CE-02	Encore - Double Lounge	Community	2	\$1,966.50	\$3,933.00
CE-04	Rectangular Magazine Table	Community	1	\$605.25	\$605.25
CE-03	Square Magazine Table	Community	1	\$495.75	\$495.75
FB-01	Fatboy Bean Bag Chairs	FatBoy	4	\$179.10	\$716.40
SW-01	Sharewall - 4'x8'	Sharewall	4	\$319.60	\$1,278.40
VS-16	Panto-SwingVF student chair	VS-America	110	\$169.94	\$18,693.84
NA-01	Teacher Chair	National	3	\$407.55	\$1,222.65
VS-02	FlipTable-RU	VS-America	11	\$456.29	\$5,019.17
MT-02	Mobile Bookshelf w/ Markerboard	Media Technologies	14	\$1,722.00	\$24,108.00
ESTIMATED CLASSROOM TOTAL (2015 DOLLARS):					\$111,781.28

MEDIA CENTER LAYOUT 2
5,395 SF

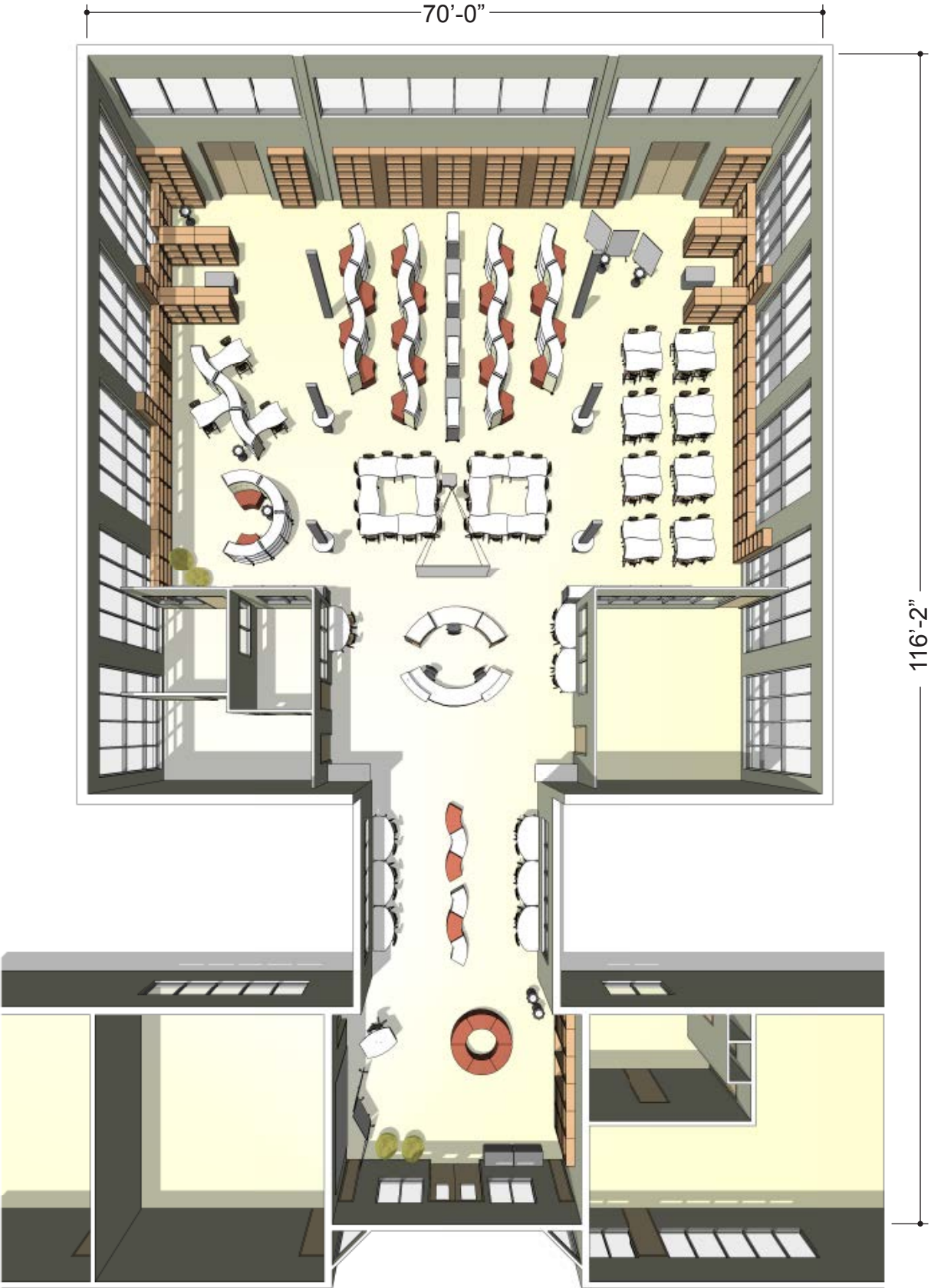

MEDIA CENTER LAYOUT 2

CODE	ITEM	MANUFACTURER	QTY.	UNIT COST	TOTAL
MT-03	Custom Circulation Desk	Media Technologies	1	\$20,000.00	\$20,000.00
VS-19	Shift+ Landscape Straight Seat	VS-America	7	\$928.87	\$6,502.10
VS-14	Shift+ Landscape 60° Seat	VS-America	29	\$913.35	\$26,487.21
VS-15	Shift+ Landscape 60° Storage	VS-America	3	\$373.26	\$1,119.77
VS-03	Hokki Stool	VS-America	7	\$89.24	\$624.68
VS-11	Shift+ Base Station Table	VS-America	9	\$350.75	\$3,156.77
VS-04	RondoLift Teacher Table	Community	1	\$1,087.18	\$1,087.18
FB-01	Fatboy Bean Bag Chairs	FatBoy	4	\$179.10	\$716.40
VS-16	Panto-SwingVF student chair	VS-America	88	\$147.44	\$12,974.72
NA-01	Teacher Chair	National	3	\$407.55	\$1,222.65
VR-03	Sage Task Lab - Teacher Chair	Virco	1	\$166.95	\$166.95
VS-07	Folding Screen	VS-America	1	\$2,835.50	\$2,835.50
SW-01	Sharewall - 4'x8'	Sharewall	4	\$319.60	\$1,278.40
VS-10	Shift+ Fusion Flip Table	VS-America	31	\$498.19	\$15,443.95
VS-12	Shift + Transfer 60° - Bookshelf	VS-America	25	\$1,149.26	\$28,731.40
VS-13	Shift+ Transfer Straight - Bookshelf	VS-America	14	\$799.28	\$11,189.92
ESTIMATED CLASSROOM TOTAL (2015 DOLLARS):					\$133,537.60

MEDIA CENTER LAYOUT 3
5,395 SF

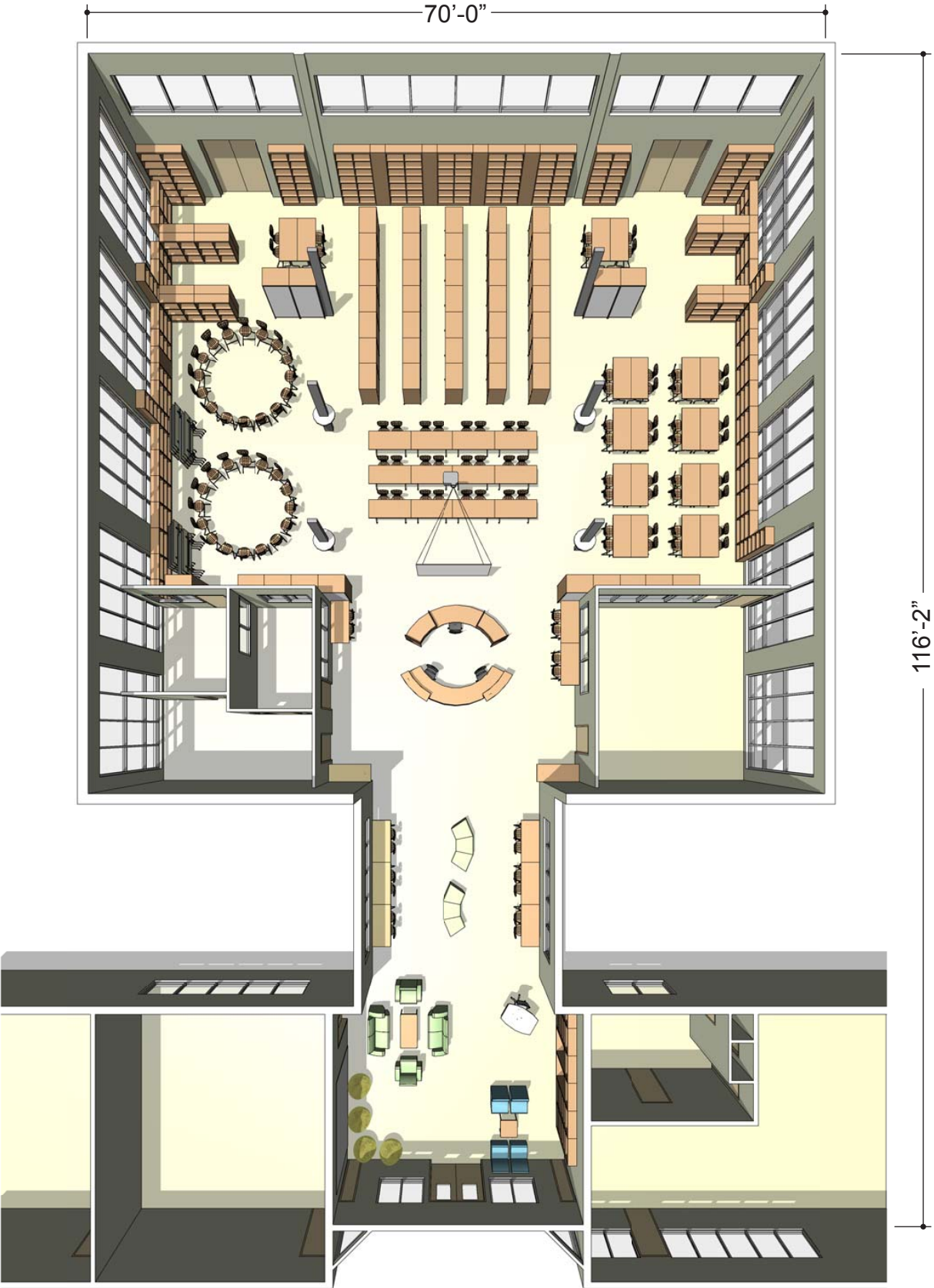

MEDIA CENTER LAYOUT 3

CODE	ITEM	MANUFACTURER	QTY.	UNIT COST	TOTAL
MT-03	Custom Circulation Desk	Media Technologies	1	\$20,000.00	\$20,000.00
MT-01	48" H Mobile Bookshelf	Media Technologies	35	\$912.65	\$31,942.75
VS-04	RondoLift Teacher Table	Community	1	\$1,087.18	\$1,087.18
FB-01	Fatboy Bean Bag Chairs	FatBoy	4	\$179.10	\$716.40
CE-05	Encore - Backless Lounge	Community	6	\$488.00	\$2,928.00
CE-06	Encore - Armless Lounge	Community	4	\$675.00	\$2,700.00
CE-01	Encore - Single Lounge	Community	2	\$1,262.75	\$2,525.50
CE-02	Encore - Double Lounge	Community	2	\$1,966.50	\$3,933.00
CE-04	Rectangular Magazine Table	Community	1	\$605.25	\$605.25
CE-03	Square Magazine Table	Community	1	\$495.75	\$495.75
VS-16	Panto-SwingVF student chair	VS-America	114	\$169.94	\$19,373.62
NA-01	Teacher Chair	National	3	\$407.55	\$1,222.65
VR-03	Sage Task Lab - Teacher Chair	Virco	1	\$166.95	\$166.95
SW-01	Sharewall - 4'x8'	Sharewall	4	\$319.60	\$1,278.40
VS-02	FlipTable-RU	VS-America	59	\$456.29	\$26,920.99
MT-02	Mobile Bookshelf w/ Markerboard	Media Technologies	14	\$1,722.00	\$24,108.00
ESTIMATED CLASSROOM TOTAL (2015 DOLLARS):					\$88,975.44

STUDENT CHAIR

BRAND: VIRCO
MODEL: SAGE CANTILEVER CHAIR
(VR-01)



FEATURES:

- large, comfortably sculpted shell
- supportive backrest
- eye-catching reverse cantilever frame

MOBILE STUDENT CHAIR

BRAND: VIRCO
MODEL: SAGE TASK CHAIR
(VR-02)



FEATURES:

- large, comfortably sculpted shell
- supportive backrest
- pneumatic seat-height adjustment

STUDENT DESK

BRAND: VS

MODEL: UNO-M (VS-01)



FEATURES:

- optional book shelf and bag hook
- universal floor glides
- extremely wear resistant top with rounded edges

STUDENT TABLE

BRAND: VS

MODEL: FLIP TABLE RU (VS-02)



FEATURES:

- lockable casters
- table top flips for storage
- table connector for grouping



VERSATILE STOOL

BRAND: VS
MODEL: HOKKI (VS-03)



FEATURES:

- facilitates free mobility
- easy to carry
- durable, fully recyclable materials

STUDENT CHAIR WITH PERSONAL WORK SURFACE

BRAND: STEELCASE
MODEL: NODE CHAIR (SC-01)



FEATURES:

- work surface accommodates right- and left-handed students
- tripod base for storage
- swivel seat and casters for mobility

TEACHER CHAIR

BRAND: VIRCO

MODEL: SAGE LAB CHAIR (VR-03)



FEATURES:

- large, comfortably sculpted shell
- supportive backrest
- high range pneumatic seat-height adjustment

TEACHER TABLE

BRAND: VS

MODEL: RONDO-LIFT (VS-04)



FEATURES:

- lockable casters
- height adjustable
- optional lockable drawer



MOBILE STORAGE - PAPER

BRAND: VS
MODEL: SERIES 600 HANDICRAFT
(VS-05)



FEATURES:

- lockable casters
- large format paper storage
- optional trays or shelves

MOBILE STORE - CUBBIES

BRAND: VS
MODEL: SERIES 600 SATCHEL
CUPBOARD (VS-06)



FEATURES:

- lockable casters
- 12 compartments for books or bags
- optional attached marker board

MOBILE BOOKCASE

BRAND: VIRCO
MODEL: METAL BOOKCASE WITH
CASTERS (VR-04)



FEATURES:

- lockable casters
- adjustable shelves

FOLDING SCREEN

BRAND: VS
MODEL: SERIES 2000 - FOLDING
SCREEN (VS-07)



FEATURES:

- 3 flexibly-jointed, mobile screens
- optional tack-board, magnetic white board, or sound absorbing panel with slits



STUDENT DESK

BRAND: VS
MODEL: SHIFT+ THUMBPRINT
CONVEX (VS-08), CONCAVE (VS-09)



FEATURES:

- available in convex and concave shapes
- lightweight and mobile
- stackable



STUDENT TABLE

BRAND: VS
MODEL: SHIFT+ FUSION FLIP
(VS-10)



FEATURES:

- lockable casters
- table top flips for storage
- table connector for grouping



COMPUTER TABLE

BRAND: VS
MODEL: SHIFT+ BASESTATION
(VS-11)



FEATURES:

- lockable casters
- common radii allows for multiple items to be combined
- optional monitor arm and integrated CPU for mobile computer station



MOBILE BOOKSHELF

BRAND: VS
MODEL: SHIFT+ TRANSFER
60° (VS-12), STRAIGHT (VS-13)



FEATURES:

- straight or 60° angle
- common radii allows for multiple items to be combined
- adjustable shelves



SOFT SEATING

BRAND: VS
MODEL: SHIFT+ LANDSCAPE SEATING MODULE
60° (VS-14), STRAIGHT (VS-19)

FEATURES:

- available in multiple heights
- straight or 60° angle
- common radii allows for multiple items to be combined



SOFT SEATING - STORAGE

BRAND: VS
MODEL: SHIFT+ LANDSCAPE
STORAGE MODULE (VS-15)

FEATURES:

- 60° angle
- common radii allows for multiple items to be combined



COLLABORATIVE WORK SPACE

BRAND: STEELCASE
MODEL: MEDIA:SCAPE LOUNGE
(SC-02)



FEATURES:

- multiple configurations available
- flexible space for collaboration

WALL-APPLIED MAGNETIC MARKER BOARD

BRAND: MOORECO INC.
MODEL: SHAREWALL (SW-01)



FEATURES:

- available in finishes for enhanced projection clarity and reduced glare
- mountable on curved surfaces
- surfaces will not retain “ghosts” of past images

STOOL

BRAND: TURNSTONE
MODEL: SCOOP STOOL
(TS-01)



FEATURES:

- simple, durable, and functional
- generous seat size
- optional upholstered cushion

BEAN BAG CHAIR

BRAND: FATBOY
MODEL: THE ORIGINAL
(FB-01)



FEATURES:

- generous size for all body types
- durable material

STUDENT CHAIR - MEDIA CENTER

BRAND: VS
MODEL: PANTOSWING VF
(VS-16)



FEATURES:

- beech plywood seat shell with anti-slip paint

STUDENT TABLE - MEDIA CENTER

BRAND: VS
MODEL: NETWORK
2 PERSON (VS-17), 4 PERSON (VS-18)



FEATURES:

- table legs have floor-leveling screws
- gap between table top and frame to accept accessories and adapters

INSTRUCTOR CHAIR - MEDIA CENTER

BRAND: NATIONAL
MODEL: MIX-IT TASK CHAIR
(NA-01)



FEATURES:

- adjustable arms, seat-slide, and knee or synchronous tilt control
- supportive, breathable mesh back

TEACHER DESK - MEDIA CENTER

BRAND: VS
MODEL: UNO-M-TEACH
(VS-20)



FEATURES:

- lockable built-in cupboard and drawer
- powder coated steel tube frame

48"H MOBILE BOOKSHELF - MEDIA CENTER

BRAND: MEDIA TECHNOLOGIES
MODEL: 31 SERIES DOUBLE FACED
TAPERED MOBILE BOOKCASE
(MT-01)



FEATURES:

- adjustable shelves
- locking casters

MOBILE STORAGE CABINET WITH MARKER BOARD BACK

BRAND: MEDIA TECHNOLOGIES
MODEL: ELEMENTS OPEN
STORAGE CABINET (MT-02)

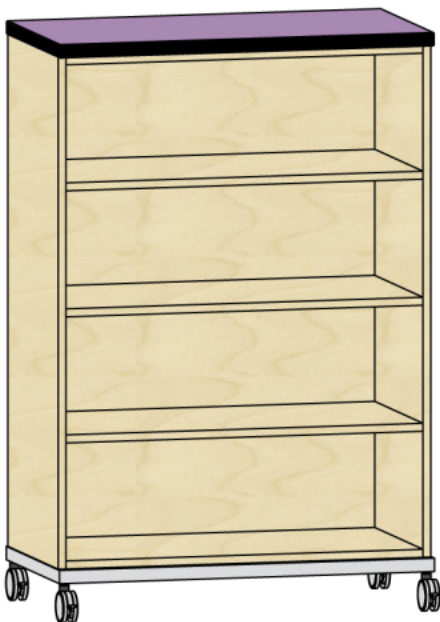

FEATURES:

- locking casters
- adjustable shelves
- porcelain marker board on back

SOFT SEATING

BRAND: COMMUNITY
MODEL: ENCORE SINGLE SEAT (CE-01)
DOUBLE SEAT (CE-02)



FEATURES:

- optional casters
- upholstered arms



MAGAZINE TABLE

BRAND: COMMUNITY
MODEL: MAGAZINE TABLE
SQUARE (CE-03), RECTANGLE (CE-04)



FEATURES:

- 17" H side table



SOFT SEATING - MODULAR BENCH

BRAND: COMMUNITY
MODEL: ENCORE 22° BENCH
(CE-05)



FEATURES:

- linking bracket attached
- modular

SOFT SEATING - ARMLESS LOUNGE

BRAND: COMMUNITY
MODEL: ARMLESS LOUNGE
(CE-06)



FEATURES:

- linking bracket
- modular

RESOURCE LINKS

Below are some helpful links for further information on creating a 21st century learning environment:

- “21st-Century Libraries: The Learning Commons” *Edutopia*
<http://tinyurl.com/nhm9rtn>
- “The Furniture Effect” *School Planning & Management*
<http://webspm.com/articles/2014/11/01/furniture.aspx>
- “Flipping Technology” *School Planning & Management*
<http://webspm.com/articles/2014/11/01/flipped-classroom.aspx>
- “Culture Shift: Teaching in a Learner-Centered Environment Powered by Digital Learning” *Alliance for Excellent Education*
<http://all4ed.org/wp-content/uploads/2013/10/CultureShift.pdf>
- Vangelova, Luba “What Does the Next-Generation School Library Look Like?” *Mind/Shift*, KQED
<http://blogs.kqed.org/mindshift/2014/06/what-does-the-next-generation-school-library-look-like/>
- “21st Century Learning Environments, Everyone’s Talking About It But What Is It Really” *Committee on Architecture for Education*, AIA
<http://tinyurl.com/pn5qkix>
- VS-America - Shift+
http://shiftplus.vs-network.com/Content/downloads/ShiftPlus_brochure.pdf
- “Bodies in Motion - Brains in Motion” VS-America
<http://tinyurl.com/ldfuso>
- Sharewall - <http://moorecoinc.com/product-view.php?category=resurfacing-048&series=sharewall-974>

